

Offset Tungsten Layout Configurations

2% Ceriated electrodes, pre-ground and cut to length, 18° included angle, .015" flat tip, .040" or 1/16" diameter. See page 49 for part numbers.

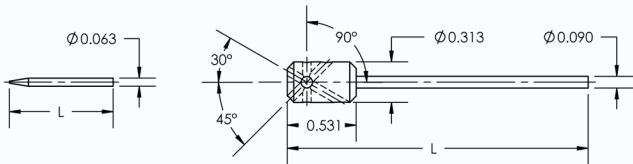
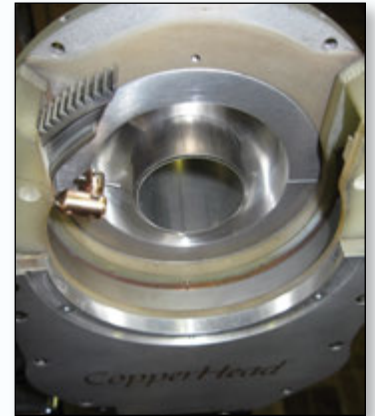
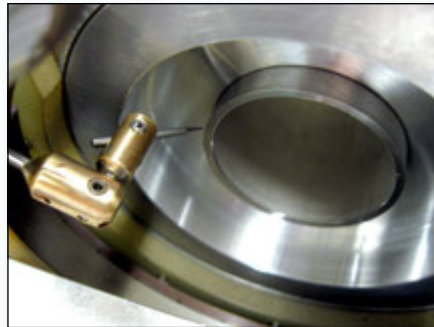

T
(TUNGSTEN
P/N: 635-063-SERIES)

X
(TUNGSTEN EXTENDER ASSEMBLY
P/N: 002-0770)

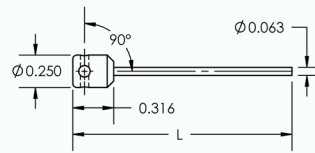

H-90
(TUNGSTEN HOLDER
ASSEMBLY 90 DEG
P/N: 002-0771)

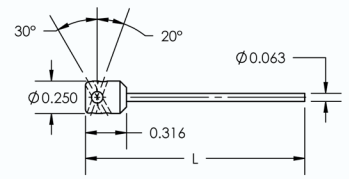

H-20/30
(TUNGSTEN HOLDER
ASSEMBLY 20 & 30 DEG
P/N: 002-0772)

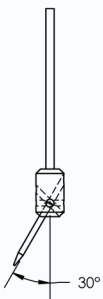

T

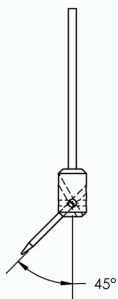

T + X

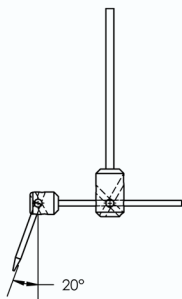

T + X + H-20/30

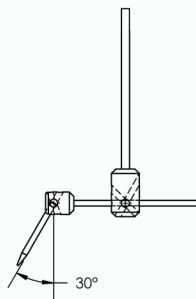

T + X + H-20/30

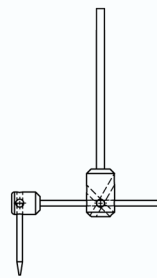

T + X + H-90

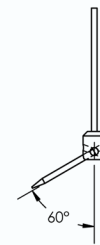

T + H-20/30

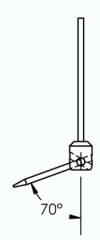

T + H-20/30

